



LET'S BUILD A BETTER FUTURE

 FRONT ENTRY DOORS / **AP** series



ECO-HOME with Aluprof

Front entry doors; aren't they one of the most important parts of our home? They protect us from the cold, the rain, and the burglars, to mention just a few examples. Doors also keeps us away from street noise. But how do you make the right choice, and buy a door that will meet our expectations and serve us for years?

An issue that requires careful consideration before the purchase is the heat transfer coefficient (U). The lower its value, the more heat will stay with us inside. Aluprof offers panelled doors with the U_D coefficient of 0.50 W/(m²K).

When choosing our door, let's not forget to check out their water resistance. It's the water resistance of the door that will keep the driving rain outside in times of strong winds and heavy rain. The higher the class, the better the door protects our home. Aluprof offers panelled doors rated E1200 (1200 Pa).

Infill panels are included in door leaves based on the MB-79N, MB-86N and MB-104 Passive system, and come in a variety of colours and structures. The elements can be milled, decorated with applications or made of insulated glass. Panelled doors can be fabricated very large and high – up to 1.40 m (W) and almost 2.60 m (H). If, therefore, we dream of an impressive front entrance, this will be the perfect choice. But above all, the door should fit to the style of your home. If our interiors are the traditional ones, we should opt for a leaf with glass panels or wooden-like veneer. Lovers of modern interior can choose among RAL colours, think shade of graphite.

Let's take some time and choose a door with which we will create a beautiful entrance that will enchant our guests and will make us feel like we were in a safe haven.

MB-104 Passive

U_D from 0.50 W/m²K

Aluprof's panel door uses thermally insulated aluminium profile system – MB-104 Passive is the most technologically advanced door system offered by Aluprof. The leaf profile can be combined with special infills, aligned with the surface of the frame. The system is dedicated to passive and energy-efficient buildings.

Elegant decorative panels, available in may different patterns and RAL colours and wood effect finishes

Design variants: SI, SI+ and AERO

Central gaskets around the leaf and the frame to seal, cover, and increase the thermal insulation of the door

Expansion joint profiles

95 mm-wide warm threshold - the same width as the threshold and frame

Technical details:	
Frame depth	95 mm
Leaf depth	95 mm
Infill panel thickness	up to 95 mm
Maximum dimensions of the leaf	L up to 1400 mm, H up to 2600 mm

Technical parameters:	
Air permeability	Class 4, EN 12207
Water tightness	Class E1200 (1200 Pa), EN 12208
Wind load resistance	Class C4/B4, EN 12210
Thermal insulation	U_D from 0.50 W/m²K
Burglary-resistance	RC2

MB-86N

U_D from 0.72 W/m²K

Aluprof's panel doors use thermally insulated aluminium profile system – MB-86N which, just like the MB-104 Passive system, is dedicated to energy-efficient and passive building. The leaf profile can be combined with special infills, aligned with the surface of the frame.

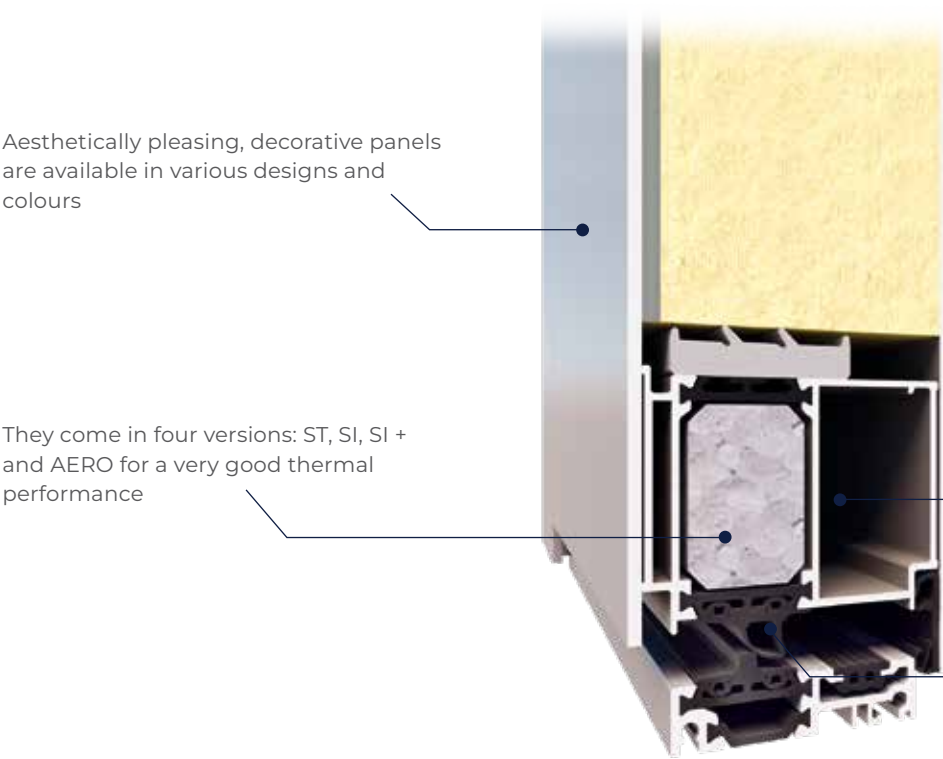

Technical details:

Frame depth	77 mm
Leaf depth	77 mm
Infill panel thickness	44, 52, 60, 65, 77 mm
Maximum dimensions of the leaf	L up to 1400 mm, H up to 2600 mm

Technical parameters:

Air permeability	Class 4, EN 12207
Water tightness	Class E900 (900 Pa), EN 12208
Wind load resistance	Class C5/B5, EN 12210
Thermal insulation	U _D from 0.72 W/m²K
Burglary-resistance	RC2

MB-79N

U_D from 0.85 W/m²K

Aluprof's panel door uses popular, thermally insulated aluminium profile system – MB-79N ST, MB-79N SI and MB-79N SI+. The leaf profile can be combined with special infills, aligned with the surface of the frame.

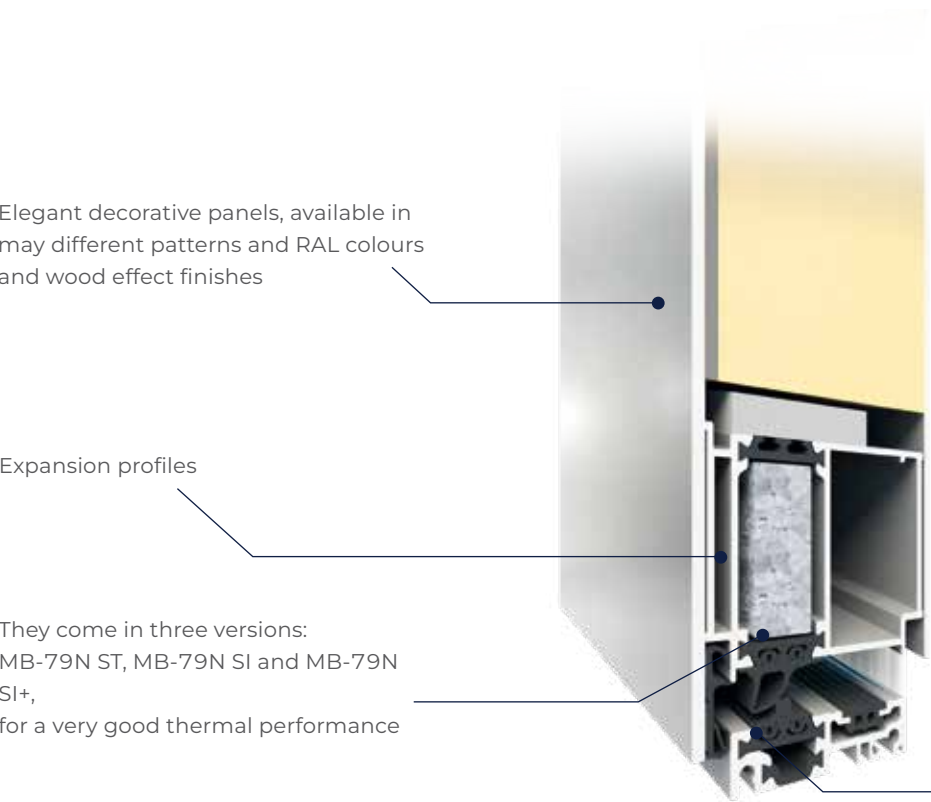

Technical details:

Frame depth	70 mm
Leaf depth	70 mm
Infill panel thickness	44, 52, 60, 70 mm
Maximum dimensions of the leaf	L up to 1400 mm, H up to 2600 mm

Technical parameters:

Air permeability	Class 3, EN 12207
Water tightness	Class E900 (900 Pa), EN 12208
Wind load resistance	Class C5/B5, EN 12210
Thermal insulation	U _D from 0.85 W/m²K
Burglary-resistance	RC2

MB-86N PIVOT DOOR – Front entry door with an off-centre rotation axis

U_D from **0.84** W/m²K

Apart from the basic single-swing version, the front entry door can also be made with an off-centre rotation axis using the MB-86N PIVOT DOOR system.

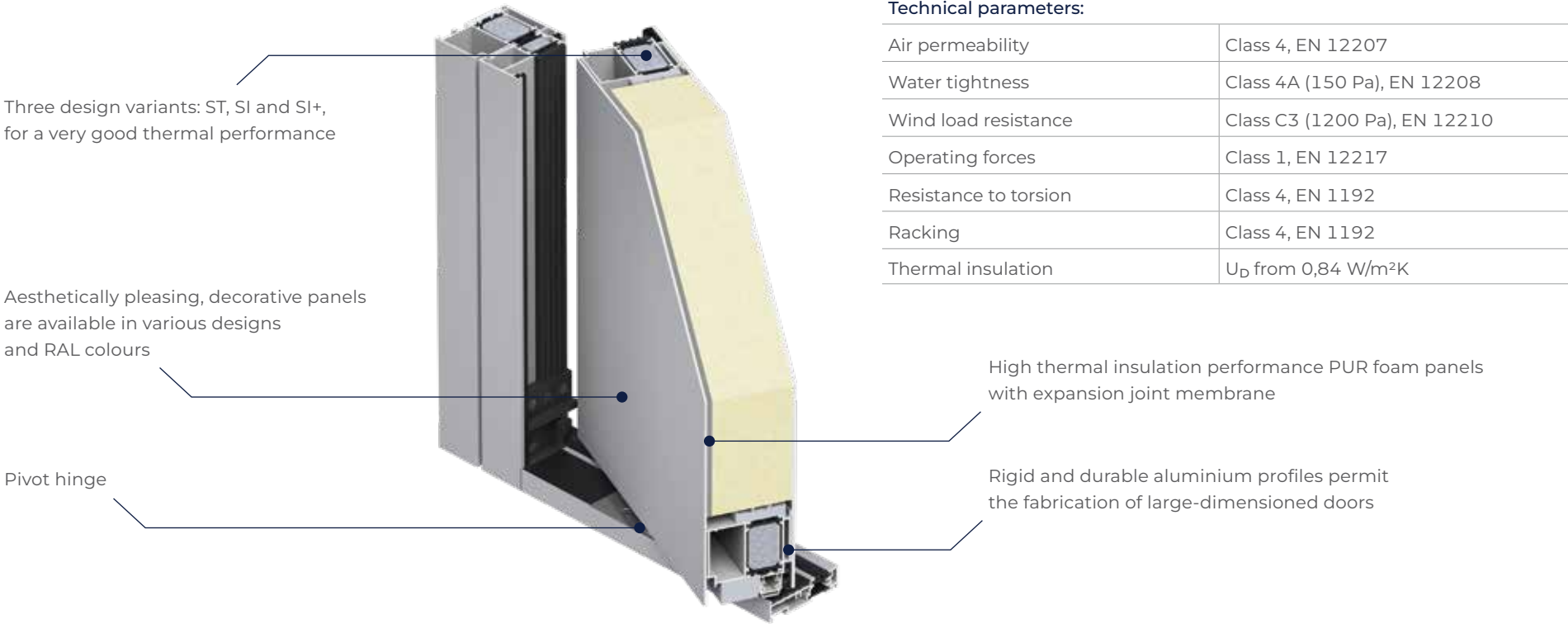

BASIC



Insert panels

- Triple glazing units U_g 0.5 (W/m²K) or U_g 0.7 (W/m²K)
- Panel thickness from 44 to 72 mm
- U-value for MB-79N SI+ door U_D from 0.98 (W/m²K), for MB-86N SI+ door U_D from 0.8 (W/m²K) and for MB-104 Passive door U_D from 0.66 (W/m²K)
- Four construction variants: ST, HI, SI, SI+ & Aero

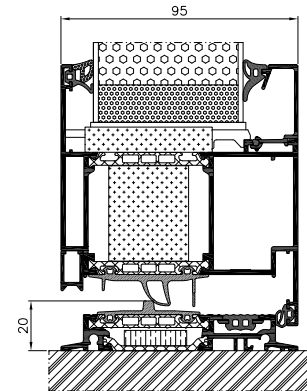

CLASSIC



Aligned on one side

- Triple glazing units U_g 0.5 (W/m²K) or U_g 0.7 (W/m²K)
- Panel thicknesses from 44 to 85 mm
- U-value for MB-79N SI+ door U_D from 0.98 (W/m²K), for MB-86N SI+ door U_D from 0.75 (W/m²K) and for MB-104 Passive door U_D from 0.61 (W/m²K)
- Four construction variants: ST, HI, SI, SI+ & Aero

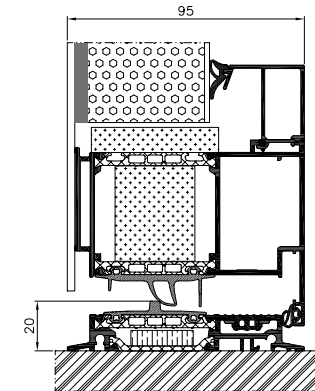

EXCLUSIVE



Aligned on both sides

- Triple glazing units U_g 0.5 (W/m²K)
- 70 mm thick panel (MB-79N), 77 mm (MB-86N) and 95 mm (MB-104 Passive)
- U-value for MB-79N SI+ door U_D from 0.85 (W/m²K), for MB-86N SI+ door U_D from 0.72 (W/m²K) and for MB-104 Passive door U_D from 0.50 (W/m²K)
- Four construction variants: ST, HI, SI, SI+ & Aero

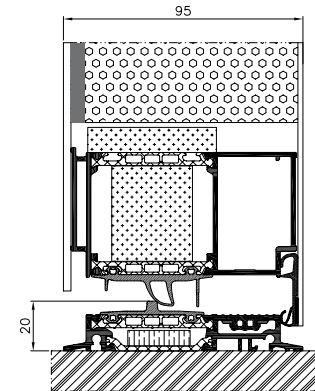

All available models can be inserted into the profiles or glued on one or both sides.



AP21
page 10



AP22
page 10



AP23
page 11



AP24
page 11



AP25
page 12



AP16
page 16



AP18
page 16



AP07
page 17



AP03
page 17



AP08
page 17



AP26
page 12



AP27
page 13



AP28
page 13



AP11
page 13



AP29
page 14



AP13
page 18



AP09
page 18

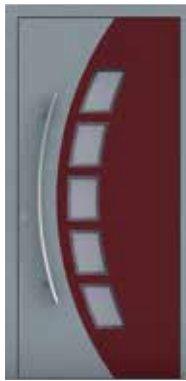

AP12
page 19



AP15
page 19



AP17
page 19



AP30
page 14

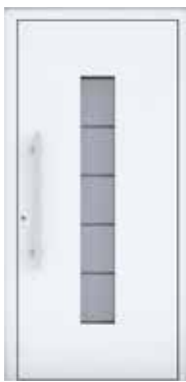

AP19
page 14

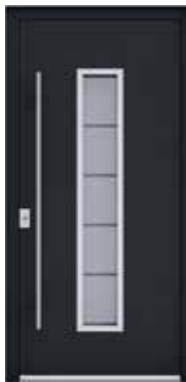

AP01
page 15



AP02
page 15

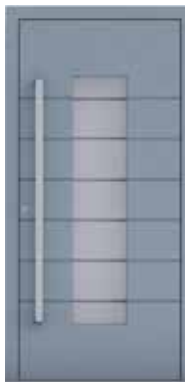

AP31
page 16



AP05
page 20



AP04
page 20



AP10
page 20



AP20
page 21



AP21 with a sidelite

- APZ 1600 flush pull handle* Flush inlay
- Alunox 5 mm; on the outside face
- Surface finish: RAL 9005



AP22

- APZ 1600 flush pull handle*
- Glass pane:
 - outer: VSG 33.1
 - middle: Satinato
 - inner: insulating glass with low-E coating
- Surface finish: RAL 7021



AP23

- APZ 1600 flush pull handle*
- 5 mm carves; on the outside face
- AP 3021 kickplate
- Surface finish: DB 703



AP24 with a sidelite

- APZ 1600 flush pull handle*
- AP 3021 kickplate
- AP 3500 anti-scratch protection
- Surface finish RAL 9016

The actual product colours may vary from the colours shown

The actual product colours may vary from the colours shown

* Models with APZ flush pull handle are available for panel thickness range of 65-95mm



AP25 with a sidelite

- AP 200.1400 door pull handle made of high-grade steel/Jatobe wood
- 5 mm flush Alunox inlay; on the outside face
- Glass pane:
 - outer: VSG 33.1
 - middle: sandblasted glass, chosen motif
 - inner: insulating glass with low-E coating
- Surface finish: RAL 9005



AP26

- AP 40.1600 door pull handle made of high-grade steel
- 5 mm flush Alunox inlay; on the outside face
- Glass pane:
 - outer: VSG 33.1
 - middle: Satinato
 - inner: insulating glass with low-E coating
- AP 3400 anti-scratch protection
- Surface finish: RAL 3004



AP27

- AP 60.1600 door pull handle made of high-grade steel
- 5 mm carves; on the outside face
- Glass pane:
 - outer: VSG 33.1
 - middle: Satinato
 - inner: insulating glass with low-E coating
- Surface finish: RAL 7016



AP28

- AP 60.1600 door pull handle made of high-grade steel
- 5 mm Alunox inlay; on the outside face
- Glass pane:
 - outer: VSG 33.1
 - middle: Satinato
 - inner: insulating glass with low-E coating
- Surface finish: RAL 9016



AP11

- AP 80.1625 door pull handle made of high-grade steel
- 5 mm Alunox inlay; on the outside face
- Glass pane:
 - outer: VSG 33.1
 - middle: sandblasted with transparent frame
 - inner: insulating glass with low-E coating
- Surface finish: RAL 9007



AP29

- AP 46.825 door pull handle made of high-grade steel, finished in black
- U-type carves; on the outside face
- Surface finish: Winchester - ADEC W645



AP30

- AP 130.1030 door pull handle made of high-grade steel
- 5 mm flush Alunox inlay; on the outside face
- Surface finish: RAL 7016



AP19

- AP 60.800 door pull handle made of high-grade steel
- Glass pane:
 - outer: VSG 33.1
 - middle: sandblasted with transparent strips
 - inner: insulating glass with low-E coating
- Surface finish: RAL 9016



AP01

- AP 40.1600 door pull handle made of high-grade steel
- Flush Alunox inlay; on the outside face
- Glass pane:
 - outer: VSG 33.1
 - middle: sandblasted with transparent strips
 - inner: insulating glass with low-E coating
- AP 3021 kickplate
- AP 3400 anti-scratch protection
- Surface finish: RAL 9005



AP02

with a sidelite

- AP 60.1600 door pull handle made of high-grade steel
- Flush Alunox inlay; on the outside face
- Glass pane:
 - outer: VSG 33.1
 - middle: sandblasted with transparent strips
 - inner: insulating glass with low-E coating
- AP 3400 anti-scratch protection
- Surface finish: RAL 7016



AP31

- AP 46.1625 door pull handle made of high-grade steel
- Carves; on the outside face
- Glass pane:
 - outer: VSG 33.1
 - middle: sandblasted with transparent strips
 - inner: insulating glass with low-E coating
- Surface finish: RAL 7001



AP16

- AP 60.1600 door pull handle made of high-grade steel
- Carves; on the outside face
- Glass pane:
 - outer: VSG 33.1
 - middle: sandblasted with transparent strips
 - inner: insulating glass with low-E coating
- Surface finish: RAL 9016



AP18

- AP 80.1625 door pull handle made of high-grade steel
- Carves; on the outside face
- Flush Alunox inlay; on the outside face
- Glass pane:
 - outer: VSG 33.1
 - middle: sandblasted with transparent strips
 - inner: insulating glass with low-E coating
- AP 3021 kickplate
- Surface finish: RAL 7015



AP07

- AP 40.1600 door pull handle made of high-grade steel
- Carves; on the outside face
- Glass pane:
 - outer: VSG 33.1
 - middle: sandblasted with transparent frame
 - inner: insulating glass with low-E coating
- Surface finish: RAL 3004



AP03

- AP 60.1600 door pull handle made of high-grade steel
- Flush Alunox inlay; on the outside face
- Glass pane:
 - outer: VSG 33.1
 - middle: Satinato
 - inner: insulating glass with low-E coating
- AP 3021 kickplate
- Surface finish: RAL 7016



AP08

- AP 80.825 door pull handle made of high-grade steel
- Glass pane:
 - outer: VSG 33.1
 - middle: sandblasted with transparent frame
 - inner: insulating glass with low-E coating
- AP 3021 kickplate
- Surface finish: RAL 9016

The actual product colours may vary from the colours shown

The actual product colours may vary from the colours shown



AP13

- AP 200.1600 door pull handle made of high-grade steel/Jatobe wood
- Flush Alunox inlay; on the outside face
- Glass pane:
 - outer: VSG 33.1
 - middle: Satinato
 - inner: insulating glass with low-E coating
- Surface finish: RAL 7016



AP09 with a sidelite

- AP 60.1400 door pull handle made of high-grade steel
- Flush Alunox inlay; on the outside face
- Glass pane:
 - outer: VSG 33.1
 - middle: sandblasted glass with transparent frame
 - inner: insulating glass with low-E coating
- Surface finish: RAL 7016/ sweet cherry - ADEC C212



AP12

- AP 50.1200 door pull handle made of high-grade steel
- Glass pane:
 - outer: VSG 33.1
 - middle: sandblasted glass with transparent frame
 - inner: insulating glass with low-E coating
- Surface finish: RAL 9007/RAL 3004



AP15

- AP 50.1200 door pull handle made of high-grade steel
- Flush Alunox inlay; on the outside face
- Glass pane:
 - outer: VSG 33.1
 - middle: Satinato
 - inner: insulating glass with low-E coating
- Surface finish: walnut - ADEC 0102



AP17

- AP 50.1200 door pull handle made of high-grade steel
- Carves; on the outside face
- Glass pane:
 - outer: VSG 33.1
 - middle: sandblasted with transparent strips
 - inner: insulating glass with low-E coating
- AP 3300 anti-scratch protection
- Surface finish: DB 703

The actual product colours may vary from the colours shown

The actual product colours may vary from the colours shown



AP05

- AP 40.1600 door pull handle made of high-grade steel
- Carves; on the outside face
- AP 3021 kickplate
- Surface finish: RAL 9005



AP04

- AP 60.1600 door pull handle made of high-grade steel
- Flush Alunox inlay; on the outside face
- AP 3021 kickplate
- Surface finish: Vintage - ADEC D825



AP10

- AP 60.1800 door pull handle made of high-grade steel
- AP 3400 anti-scratch protection
- AP 3020 kickplate
- Surface finish: RAL 9006



AP20

- AP 60.1600 door pull handle made of high-grade steel
- Glass pane:
 - outer: VSG 33.1
 - middle: sandblasted chosen motif
 - inner: insulating glass with low-E coating
- AP 3400 anti-scratch protection
- Decorative elements: ornamental frame on the outside
- Surface finish: Vien walnut - ADEC O102



Pull handle



AP 40

pull handle, dia. 30 mm
(right-angle holders),
stainless steel,
matte, polished

• AP 40.600	30×600 mm
• AP 40.800	30×800 mm
• AP 40.1000	30×1000 mm
• AP 40.1200	30×1200 mm
• AP 40.1400	30×1400 mm
• AP 40.1600	30×1600 mm
• AP 40.1800	30×1800 mm



AP 60

pull handle, 40 × 10 mm
(right-angle holders),
stainless steel,
matte, polished

• AP 60.600	40×10×600 mm
• AP 60.800	40×10×800 mm
• AP 60.1000	40×10×1000 mm
• AP 60.1200	40×10×1200 mm
• AP 60.1400	40×10×1400 mm
• AP 60.1600	40×10×1600 mm
• AP 60.1800	40×10×1800 mm



AP 100

pull handle, 30 × 30 mm
(right-angle holders),
stainless steel,
matte, polished

• AP 100.600	600 mm
• AP 100.800	800 mm
• AP 100.1000	1000 mm
• AP 100.1200	1200 mm
• AP 100.1400	1400 mm
• AP 100.1600	1600 mm
• AP 100.1800	1800 mm



AP 80

pull handle, 40 × 10 mm
(right-angle holders),
stainless steel, matte, polished
or black finished

• AP 80.625	625 mm
• AP 80.825	825 mm
• AP 80.1025	1025 mm
• AP 80.1225	1225 mm
• AP 80.1425	1425 mm
• AP 80.1625	1625 mm
• AP 80.1825	1825 mm



AP 50

pull handle, dia. 30 mm
(holders bent to the side),
stainless steel, matte,
polished

• AP 50.600	30x600 mm
• AP 50.1000	30x1000 mm
• AP 50.1200	30x1200 mm



AP 200

pull handle, dia. 35 - 40 mm
(right-angle holders),
Jatobe/stainless steel,
matte, polished

• AP 200.800	800 mm
• AP 200.1200	1200 mm
• AP 200.1600	1600 mm



AP 130

pull handle, 30 × 20 mm
(right-angle holders),
stainless steel,
matte, polished

• AP 130.630	630 mm
• AP 130.830	830 mm
• AP 130.1030	1030 mm
• AP 130.1230	1230 mm
• AP 130.1430	1430 mm
• AP 130.1630	1630 mm



AP 30

pull handle, dia. 30 mm
(holders turned 45 deg.),
stainless steel,
matte, polished

• AP 30.600	30×600 mm
• AP 30.800	30×800 mm
• AP 30.1000	30×1000 mm
• AP 30.1200	30×1200 mm
• AP 30.1400	30×1400 mm
• AP 30.1600	30×1600 mm
• AP 30.1800	30×1800 mm



AP 70

pull handle, 40 × 10 mm
(holders turned 45 deg.),
stainless steel,
matte, polished

• AP 70.600	40×10×600 mm
• AP 70.800	40×10×800 mm
• AP 70.1000	40×10×1000 mm
• AP 70.1200	40×10×1200 mm
• AP 70.1400	40×10×1400 mm
• AP 70.1600	40×10×1600 mm
• AP 70.1800	40×10×1800 mm



AP 110

pull handle, 30 × 30 mm
(holders turned 45 deg.),
stainless steel,
matte, polished

• AP 110.600	600 mm
• AP 110.800	800 mm
• AP 110.1000	1000 mm
• AP 110.1200	1200 mm
• AP 110.1400	1400 mm
• AP 110.1600	1600 mm
• AP 110.1800	1800 mm



AP 90

pull handle, 40 × 10 mm
(holders bent forward),
stainless steel,
matte, polished

• AP 90.600	600 mm
-------------	--------



AP 46

pull handle, 40 × 25 mm,
semi-circular (right-angle
holders), stainless steel, matte,
polished or black finished

• AP 46.625	625 mm
• AP 46.825	825 mm
• AP 46.1025	1025 mm
• AP 46.1225	1225 mm
• AP 46.1425	1425 mm
• AP 46.1625	1625 mm
• AP 46.1825	1825 mm



AP 210

pull handle, dia. 35 - 40 mm
(holders turned 45 deg.),
Jatobe/stainless steel,
matte, polished

• AP 210.800	800 mm
• AP 210.1200	1200 mm
• AP 210.1600	1600 mm



AP 270

horizontal pull handle

• AP 270	60x550mm
----------	----------



AP 250

horizontal pull handle

• AP 250	480×65mm
----------	----------

Available colours:



stainless steel black

Available colours:



stainless steel black

Lever handles



lever handle: 1924216X
stainless steel, natural
anode and inox, white,
anthracite, black



lever handle: 1924218X
escutcheon: 1924230X
stainless steel, natural anode and
inox, white, anthracite, black



lever handle: 1924111X
escutcheon: 1924113X
RAL colours



lever handle: 8001289X
escutcheon: 1924113X
RAL colours, natural
anode, faux anode

Aluprof offers a wide range of kickplates and door protection plates as anti-scratch protection of the door surface.

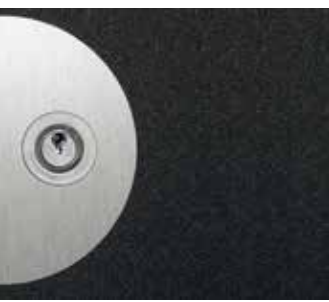

AP 3300
Flush anti-scratch protection,
Alunox

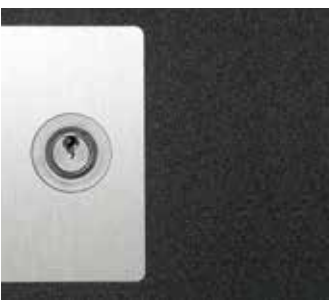

AP 3400
Flush anti-scratch protection,
Alunox



AP 3500
Flush anti-scratch protection,
Alunox



AP 3000
Flush kickplate – Alunox

130 mm high



AP 3020
Flush kickplate – Alunox

60 mm high



AP 3021
Flush kickplate – Alunox

30 mm high

Wood-like coatings and RAL colours



// RAL & structural colours*



* All RAL colours and structural colours as per the offer.
The colours may vary slightly from the finished product.

// Ornaments and glazing



Aluprof offers a wide range of glass with motif, glass made of transparent or ornamental glass in its most popular models

All door models come in variants with sidelight and toplight.

- Version 1: glass with motif
- Version 2: transparent glass
- Version 3: ornamental glass

Sidelights and fixed lights include triple glazing units with warm glass spacers. Sidelights (fixed glazing) can be placed either on one or on both sides of the door assembly. Maximum sidelight width: 1400mm.

Triple glazing: U_g - from 0.5 to 0.7 W/m²K
For depth of frame from 44-85 mm
(black, warm edge spacer bar)

outer: 6 mm laminated safety glass (VSG)
middle: sandblasted glass/ leaded stained glass / insulating glass with low-E coating
inner: insulating glass with low-E coating

Quadruple glazing: U_g - 0.5 W/m²K
For 95 mm frame depth
(black, warm edge spacer bar)

outer: 6 mm laminated safety glass (VSG)
middle I: sandblasted glass / leaded stained glass /insulating glass with low-E coating
middle II: insulating glass with low-E coating
inner: insulating glass with low-E coating

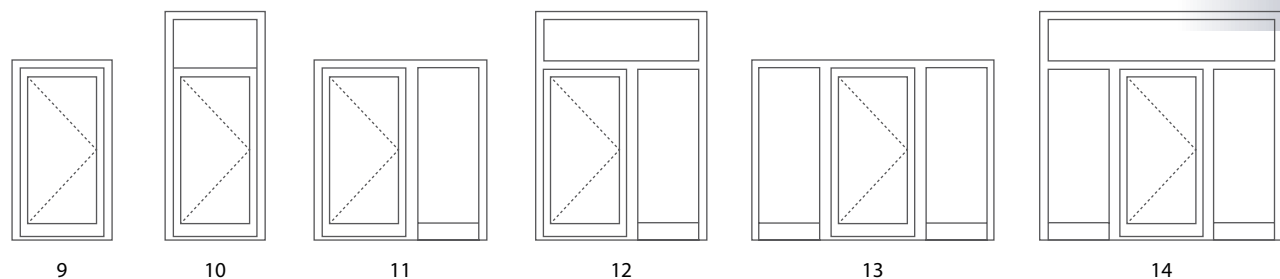
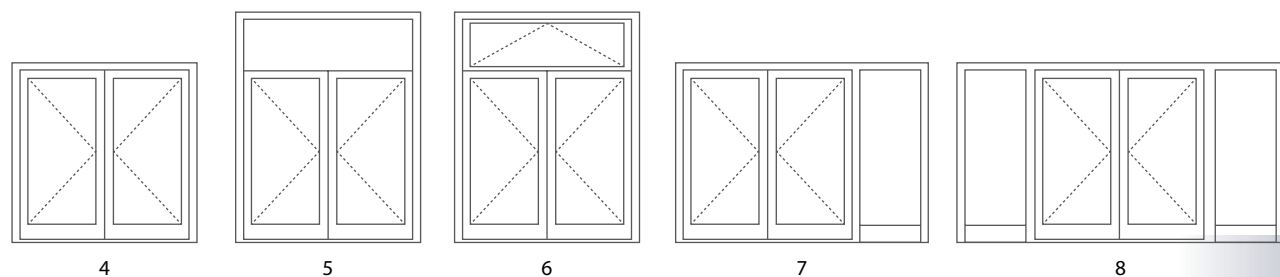
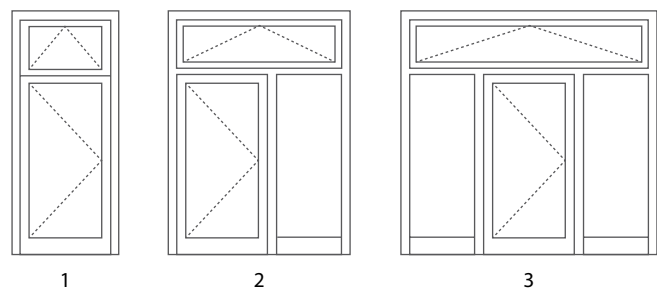

WWW.HOME.ALUPROF.COM

Please visit our site www.home.aluprof.com to learn more on energy-efficient aluminium systems for the construction industry.





Scan the QR code
and download the PDF
onto your mobile device

ALUPROF

ALUMINIUM SYSTEMS

ALUPROF SA

ul. Warszawska 153, 43-300 Bielsko-Biała, Poland
tel. +48 33 81 95 300, fax +48 33 82 20 512
e-mail: aluprof@aluprof.eu